

INNOVATIONS 2021



**BEST
SELLER**
INCLUDED



INNOVATIONS 2021



Management
Eckhard Wefing
Manfred Wippermann
Marc Hogrebe

2020 is an unusual year: the lockdown in spring and the continuing restrictions imposed by corona are turning the world upside down.

We are now all the more pleased to present new product releases that aim to help you boost your sales and noticeably upgrade your showroom. All of our innovations have the potential to become bestsellers.

Particularly for your discerning customers, you can use our products to design on-trend and attractive kitchens which will leave them wanting for nothing. At the same time, we also offer you a wide range of clever solutions and details that will let you stand out from the crowd.

This year, independent auditors have given us confirmation that we manufacture our products on an environmentally friendly basis and use sustainable materials. Both are central elements of everything we do.

The following pages show you all of the key new releases and trends for the coming kitchen season.

Look forward to our innovations for 2021 – bestsellers included!



For the third time
in succession:
Germany's favourite
kitchen brand.

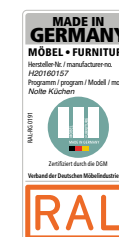

We produce in Germany –
also officially certified by the Verband
Deutsche Möbelschaffende e.V.,
the association of the German furniture
industry.



The golden M guarantees
proven quality, safety and
healthy living.



A healthy environment is also the basis
of our track record of success. It is for
this reason alone, that we work on a
climate-neutral basis.

BESTSELLER included



Symbiosis of storage space and design

Our new wall-unit height of 105 cm is unbeatable in terms of design and storage space!



Perfect throughout

Perfect your planning with the new uninterrupted doors for tall units and appliance cabinets!



On-trend decors

From oak graphite silver and volcanic oak to white concrete and the cement decors from LUCCA, we can offer you the latest on-trend decors!



The crowing glory for MatrixArt

The illuminated vertical recessed handle profile lets you create a further highlight in handleless kitchens!



MANHATTAN • SOFT LACK

White needs contrasts

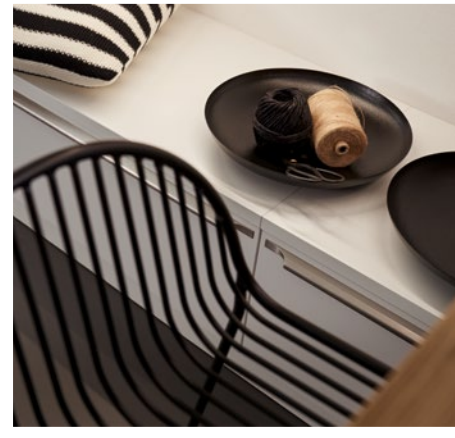

The new MANHATTAN volcanic oak offers contrasts galore. The distinctive decor ideally complements calm SOFT LACK. The new wall unit height of 105 cm gives this kitchen a very individual look. The units are perfectly complemented by the open shelves and white lowboard.

MANHATTAN 489 - Volcanic oak • **SOFT LACK 76W** - White soft mat
Carcase ED9 - Volcanic oak • Worktop E39 - Volcanic oak • Handle trim 675 - Stainless steel look



Carcase height 105 cm

Delicately restrained – with much more space

After years of emphasising the horizontal, the trend is now returning to slim, vertical design elements.

So, what could be more obvious than giving our wall units 15 cm more height? You can now plan heights of up to 105 cm in the MATRIX 150 increment grid. Creating a wealth of new options in kitchen design.

The best part: it leaves customers wanting for nothing when it comes to planning their kitchen. In addition to wall units with hinged doors, there's a choice of display cabinets, shelf units and much more besides. You can even feature surrounds for cooker hoods. Find more details on available types by turning to pages 44/45.



Volcanic oak

Oak with a modern touch

Expressive timbers – some with blackened knots – are right on trend these days. And when the decor comes in a colour shade as warm as this one, the future bestseller is virtually waiting to happen. Because volcanic oak provides the homeliness of chalet oak, yet with a modern touch!

What's more, it is also the perfect contrast to smooth plain-coloured fronts. And the ideal partner for white – as depicted here, for example, with the SOFT LACK.



Elegant solution

The new surface-mounted G 675 handle trim skilfully combines the elegance of a recessed handle trim with the benefits of a classic handle.



Both inside and out – of course!

The new volcanic oak decor once again impressively demonstrates how the interior decor from Nolte Küchen helps to conjure a homely feel!

Exquisite on the outside, and on the inside too!

There's never enough storage space

A kitchen, of course, not only needs to look good, it should also offer storage space for dishes and provisions for the whole family on an everyday basis.

Not a problem – because the Nolte Küchen range gives you the right furniture for every need and expectation.



Clean air thanks to Ozonos Aircleaner

With its innovative technology, the Ozonos Aircleaner not only provides clean air in the kitchen but in all other rooms too. Besides eliminating bad odours, it also effectively kills germs, bacteria and even viruses.



**BEST
SELLER**
INCLUDED

STONE

Pared down to the essential



This composition shows you how to create an impressive kitchen with the consistent interplay of black and white. The new STONE in concrete white provides a wonderful contrast with the elements in black. Illuminated MatrixArt handle trims and shelf units with integrated lighting make inviting statements in this otherwise purist-looking kitchen..

STONE 267 - White concrete • Carcase PWD - Premium white
Worktop C30 - White concrete - Handleless MatrixArt 591 - Black



Opposites attract

The consistent interplay of black and white

Nolte Küchen gives you a wide range of options for accentuating white kitchens with contrasting highlights: illuminated shelf units, black handle trims that can be illuminated too, and all the many other options that are available.

From now on there's a further front with STONE white concrete to let you orchestrate vibrant contrasts with absolute perfection.

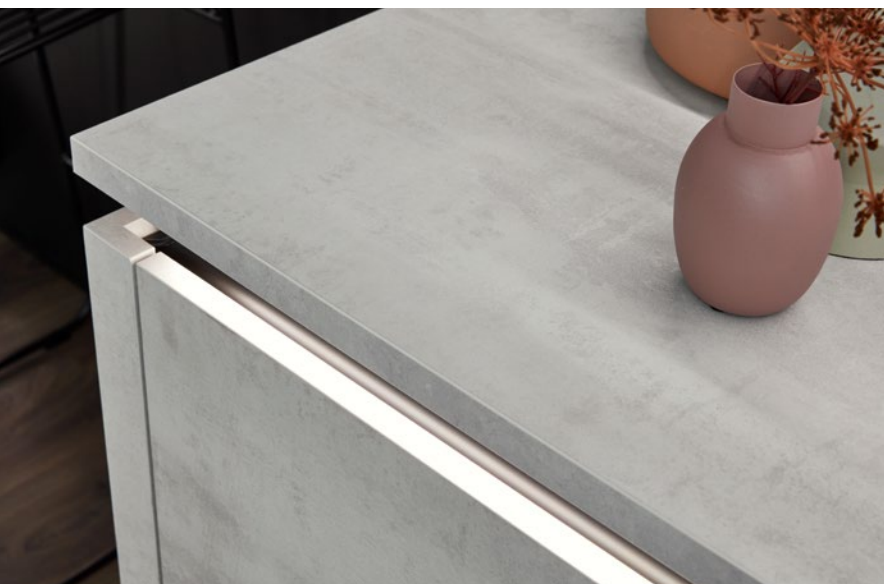

STONE white concrete – Bestsellers times two

Most kitchens are sold in white or a shade of white. So, what could be more obvious now than to offer concrete in white as well? The ideal combination of two on-trend themes!



**BEST
SELLER**

The crowing glory for handleless kitchens

MatrixArt: vertical handle trim profiles with lighting

The vertical MatrixArt handle trim profile can now also be illuminated from end to end with Emotion Light.

The LEDs remain hidden from view from whichever direction you see them. An innovation that creates new design options.

In this case, the lighting slightly subdues the contrast as a result of the black handle trim profile. This makes the handle trim look more slender while creating an understated source of light.

Needless to say, this lighting can be provided for all MatrixArt handle trim profile colours!

**BEST
SELLER**
INCLUDED

MANHATTAN

Individual-looking design in graphite silver



The new MANHATTAN in oak graphite silver is a welcome, uncomplicated combination partner. It provides many different options and impresses with its expressive graining – whether tone-in-tone (e.g. with sahara) or, as shown here, with elements in black.

MANHATTAN 486 - Oak graphite silver • End panels ED6 - Oak graphite silver
Carcase QGD - Quartz grey • Worktop E36 - Oak graphite silver • Handle trim 676 - Black anodised



**BEST
SELLER**

Oak graphite silver

Wood with character

The new oak graphite silver decor is extremely easy to combine, whether as a worktop, side panel or, as illustrated here, in the form of a kitchen front (MANHATTAN).

Oak graphite silver is a contemporary interpretation of the grey timber theme – with clear potential to become a bestseller!

A real eye-catcher in black

Display units with black aluminium frame

This display unit with black mat anodised aluminium frame and black tinted glass makes a real statement. The frame also comes with an integrated handle trim.

And this display unit with integrated lighting at the side cuts a particularly elegant figure too.



Competent edge

The new 676 handle trim in black gives you a further way of making contrasts on the front.

**BEST
SELLER**



**BEST
SELLER**
INCLUDED

FOCUS

Classics re-interpreted



The new FOCUS brings modern country style to the kitchen. The new framed design is unfussy, lightweight in looks and almost purist.

The appliance block interrupting the row of units at the back gives this kitchen a look that could, for all intents and purposes, be American in the way it feels. Illuminated display cabinets as base units open up the island to the living area.

FOCUS 83P - Platinum grey soft mat • Carcase PGD - Platinum grey
Worktop U23 - Black PRO • Handle 317 - Stainless steel look



**BEST
SELLER**

It's all in the frame

Delicate and right on trend

Its slim-line frames give FOCUS rather a delicate look, putting it on the cutting edge of today's trends. Besides platinum grey, the front is also available in white – providing ample scope for planning classic dream kitchens!



**BEST
SELLER**

But it doesn't stop at 105 cm

Top-mounted units create even more height

Our new wall unit height of 105 cm cuts a great figure in classic kitchens too! Not only providing more storage space, it creates a new, vertical look that can be enhanced yet further with matching add-on units. Simply perfect – particularly in a kitchen of this hilt!

**BEST
SELLER**
INCLUDED

LUCCA

Cement look for everyone



With the LUCCA, our successful PORTLAND product in real cement, now makes an entrance in budget-segment kitchens too. Reproduction of the genuine material now gives you even more scope for meeting your customers' wishes.

The new worktop in beech heart fits in perfectly and generates a contrasting element – for example, with the cement look in anthracite as shown here.

LUCCA 244 - Cement anthracite • Carcase QGD - Quartz grey
Worktop B25 - Beech heart • Handle combination 848 - Titanium look, brushed



Beech heart

**BEST
SELLER**

A timber completely different

Beech heart is the alternative for all those who want something refreshingly different. The worktop with distinctive knots harmonises with both dark and light colour shades.



Deceptively real reproduction

LUCCA – looking like PORTLAND

Of course: PORTLAND is unbeatable in terms of individuality. After all, every front is hand-crafted and one of a kind. Something you and your customers have doubtlessly come to appreciate – as a track record of success has demonstrated.

Yet the LUCCA now provides an attractive alternative. The decor is identical with the real McCoy in every sense, and is available in the same finishes as its genuine cement counterpart: cement sapphire grey, cement agate grey and cement anthracite.

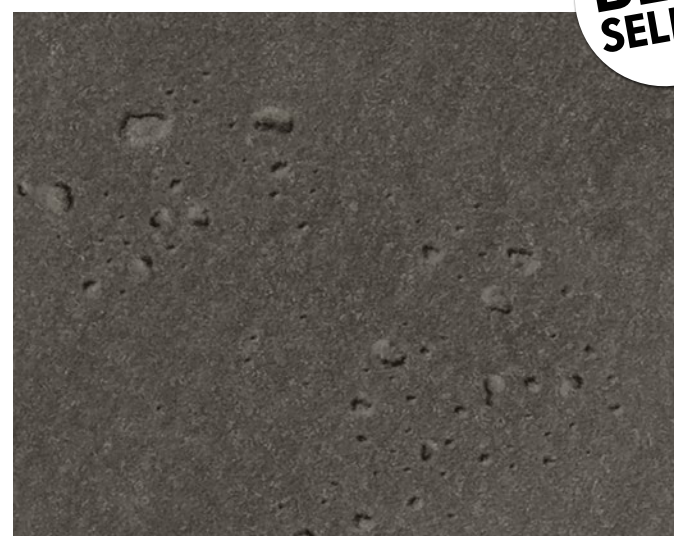

**BEST
SELLER**



Handle with character

The new 848 handle combination is not only highly unusual in terms of shape: the titanium look also makes a particularly elegant and provides a welcome contrast, say, with the LUCCA in cement anthracite.

**BEST
SELLER**
INCLUDED

NOVA LACK

Breath of fresh air for long-standing bestsellers



This kitchen is the best example of how even tried and proven lines, such as the NOVA LACK, are given a new look with some of this year's innovations: uninterrupted tall and appliance unit doors give the kitchen a very neat and tidy look. An aspect reinforced yet further by the new MatrixArt handle trim profiles in premium white. The new oak barriqué worktop decor provides the appropriate surrounding element.

NOVA LACK 731 - High gloss white • Carcase PWG - Gloss premium white
Worktop E35 - Oak barriqué • Handleless MatrixArt 790 - Premium white

Perfection through and through

Tall units and appliance cabinets with uninterrupted doors

Anyone wishing to follow the trend towards a tidy, clean-looking kitchen with generous, large surfaces has no other option: tall units and appliance cabinets with uninterrupted doors.

Featured as standard, anti-warp fittings make sure these doors continue to close perfectly and don't warp even after prolonged use.

**BEST
SELLER**



Oak barriqué

Classic with a new twist

Classic oak is now available in an even more vibrant option. This makes oak barriqué harmonise in particular with light plain colours – as in this NOVA LACK high gloss white.

**BEST
SELLER**

Flap door closed, everything out of view

Egg boiler and kettle, espresso machine and mixer: many kitchen appliances have become lifestyle objects. When they start to get out of hand but are still needed every day, this is where the new top-mounted unit with lift-up door comes into its own.



Tone-in-tone as a highlight too

Illumination for the vertical MatrixArt handle trim profile

The illuminated vertical MatrixArt handle trim profile is always a highlight: whether contrasting with a black profile or, as in this case, understated and tone-in-tone with a premium white profile.

**BEST
SELLER**
INCLUDED

TAVOLA • PLUS

Homeliness in a new dimension



The dominating elements in this kitchen are genuine barolo oak and classy black. Uninterrupted tall units with open shelf units and display cabinets with black aluminium frames create a combination second to none. Entirely in black, the island is subtly relaxed by glass display units. There you have it: this is homeliness in a new dimension!

TAVOLA 572 - Oak barolo • **PLUS 60S** - Black soft mat • Carcase QGD - Quartz grey
Worktop U23 - Black PRO • Handle trim 561 - Black anodised



All a matter of combination

High-quality materials brought together for a look that's right on trend

Black not only creates a contrasting ambience in combination with white but also looks extremely classy with timber finishes while also providing exactly the right complement.

The black anodised aluminium on the display units meets genuine barolo oak on the tall unit, adding an element of interest and utter suspense.



Uninterrupted tall-unit doors

The uninterrupted tall-unit doors not only cut an impressive figure with MatrixArt. Especially combined with Push-to-Open fittings, the kitchen looks particularly neat and tidy.

Featuring display units with black aluminium frames, the kitchen almost takes on the appearance of a living room!



**BEST
SELLER**

Display units with black anodised aluminium frame

The display cabinets with black aluminium frame are always a highlight at base-unit level too. Here, in the island, they harmonise perfectly with the other base units in PLUS black soft mat. Integrated lighting conjures an ambience that extends an invitation to stay.





Carcase
ED9 Volcanic oak



Fronts 2021

PG1 | M15 **MANHATTAN**
Melamine resin mat

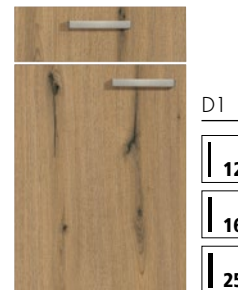

489 Volcanic oak

Surrounding elements:
ED9 Volcanic oak
(Carcase, shelf units, plinth,
claddings / filler panels
gallery shelves, ceiling panels,
KP2/LB2)



486 Oak graphite silver

Surrounding elements:
ED6 Oak graphite silver
(Visible sides, shelf units, plinths,
claddings / filler panels
ceiling panels)

PG1 | L23 **LUCCA**
Melamine resin mat

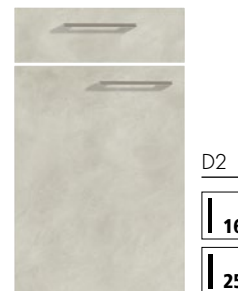

245 Cement
sapphire grey

Surrounding elements:
Z15 Cement sapphire grey
(Plinth)



243 Cement agate grey

Surrounding elements:
Z13 Cement agate grey
(Plinth)



244 Cement anthracite

Surrounding elements:
Z14 Cement anthracite
(Plinth)

PG2 | S70 **STONE**
Melamine resin mat

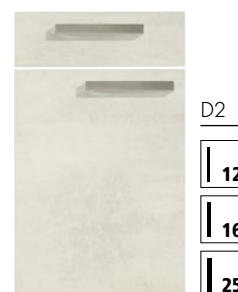

267 White concrete

Surrounding elements:
BEW White concrete
(Plinth)

PG3 | F20 **FOCUS**
3D lacquered laminate

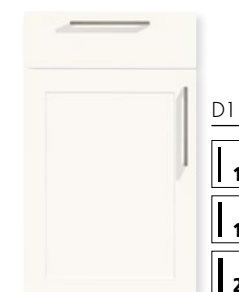

831 White soft mat

Surrounding elements:
PWD Premium white
(Carcase, shelf units, plinth,
claddings / filler panels
gallery shelves, ceiling panels,
KP2+5/LB2+5)

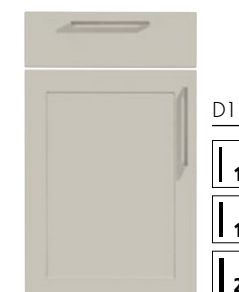

83P Platinum
grey soft mat

Surrounding elements:
PGD Platinum grey
(Carcase, shelf units, plinth,
claddings / filler panels
gallery shelves, ceiling panels,
KP2+5/LB2+5)

Future bestsellers

Whether MANHATTAN in volcanic oak or in oak graphite silver, LUCCA in cement decors or STONE or FOCUS, they all share one thing in common: everything it takes for a future bestseller!

By the way, volcanic oak as a carcass decor impressively demonstrates why Nolte kitchens are becoming spaces to feel at home and live in. Because featured both inside and out, the decor creates homely warmth throughout.



Handles and handle combinations

Design to put your finger on

The new handles complement the product line-up. These new additions now give you even more ways of creating exciting kitchens and of making statements targeted to impress.

HANDLE 338



Stainless steel look, metal
✧ ✧ 160 mm

HANDLE COMBINATION 848



Titanium look, brushed, metal
✧ ✧ 32/160 mm

Front width	✧ ✧
150 – 350 mm	32 mm
400 – 1200 mm	160 mm

HANDLE COMBINATION 849



Stainless steel look, metal
✧ ✧ 160/320 mm

Front width	✧ ✧
200 – 400 mm	160 mm
450 – 1200 mm	320 mm

HANDLE COMBINATION 850



Black, metal
✧ ✧ 160/320 mm

Front width	✧ ✧
200 – 400 mm	160 mm
450 – 1200 mm	320 mm

HANDLE TRIM 675



Stainless steel look, metal
adjusted to front width
150 – 1200 mm

Can be used in following ranges:

Artwood	Metal
Feel	Nova Lack
Ferro	Plus
Flair	Portland
Legno	Soft Lack
Lucca	Stone
Lux	Tavola
Manhattan	Titan
Manhattan Uni	Trend Lack

HANDLE TRIM 676



Black anodised, metal
adjusted to front width
150 – 1200 mm

Can be used in following ranges:

Artwood	Metal
Feel	Nova Lack
Ferro	Plus
Flair	Portland
Legno	Soft Lack
Lucca	Stone
Lux	Tavola
Manhattan	Titan
Manhattan Uni	Trend Lack

HANDLE TRIM 621



Black anodised, metal
adjusted to front width
150 – 1200 mm

Can be used in following ranges:

Artwood	Metal
Feel	Nova Lack
Ferro	Plus
Flair	Portland
Glas Tec Plus	Soft Lack
Glas Tec Satin	Stone
Legno	Tavola
Lucca	Titan
Lux	Trend Lack
Manhattan	
Manhattan Uni	

**BEST
SELLER**

Worktops

Highly expressive down to the smallest detail

Our new collection also cuts an impressive figure when it comes to worktops and side panels:

Volcanic oak, oak graphite silver and white concrete give you the key to designing kitchens from one and the same mould. Our beech heart and oak barriqué give you two distinctive timbers. And terra mare, a universally applicable, authentic stone decor, to accentuate a kitchen in a way that is guaranteed to enthrall.



B25 Beech heart



E39 Volcanic oak



E36 Oak graphite silver



E35 Oak barriqué



C30 White concrete

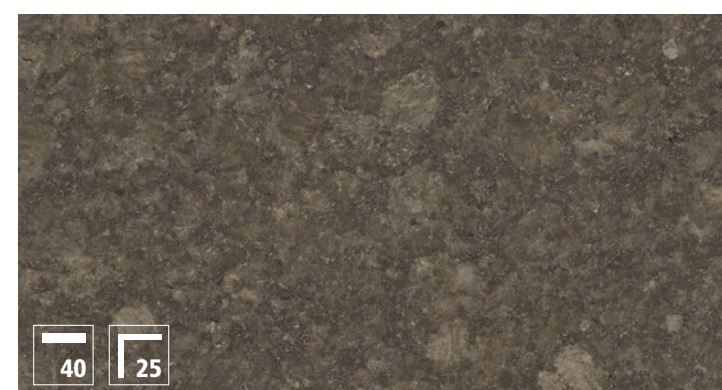

C31 Terra Mare

50 mm counter element for worktops

With immediate effect, counter elements are now also available for worktops in 50 mm thickness! By the same token, decors are available to match the 100 mm counter elements.



THEKE-EL-50MM



MatrixArt handle trim profile

Premium white

For a consistent, overall look in the kitchen

Premium white is now available for the MatrixArt handle trim profiles in addition to stainless steel look, black, quartz grey and arctic white. This complements the colour spectrum in this segment too.

Handle trim profile **790**
Premium white



Inviting ambience

Illumination for the vertical MatrixArt handle trim profile

What's long been fashionable for the horizontal MatrixArt handle trim profiles is now also available for their vertical counterparts: illumination by Emotion Light.

We have met the expectations of keeping the LEDs hidden from view from any angle and developed a perfected solution.

It provides even, indirect profile illumination, creating an inviting ambience!

Available
from 1.1.2021



ILLUMINATED VERTICAL HANDLE TRIM C-PROFILE

between two tall units

Height 1050 mm	YP-C-105-EMO
Height 1350 mm	YP-C-135-EMO
Height 1500 mm	YP-C-150-EMO
Height 1950 mm	YP-C-195-EMO
Height 2100 mm	YP-C-210-EMO
Height 2250 mm	YP-C-225-EMO

Variable height up to 3000 mm	YP-C-300-EMO
----------------------------------	---------------------

ILLUMINATED VERTICAL HANDLE TRIM L-PROFILE

at the end of tall units with end panels

Height 1050 mm	YP-L-105-EMO
Height 1350 mm	YP-L-135-EMO
Height 1500 mm	YP-L-150-EMO
Height 1950 mm	YP-L-195-EMO
Height 2100 mm	YP-L-210-EMO
Height 2250 mm	YP-L-225-EMO

Variable height up to 3000 mm	YP-L-300-EMO
----------------------------------	---------------------

Available in the following finishes:

- 595** Stainless steel look
- 593** Quartz grey
- 591** Black
- 598** Arctic white
- 790** Premium white

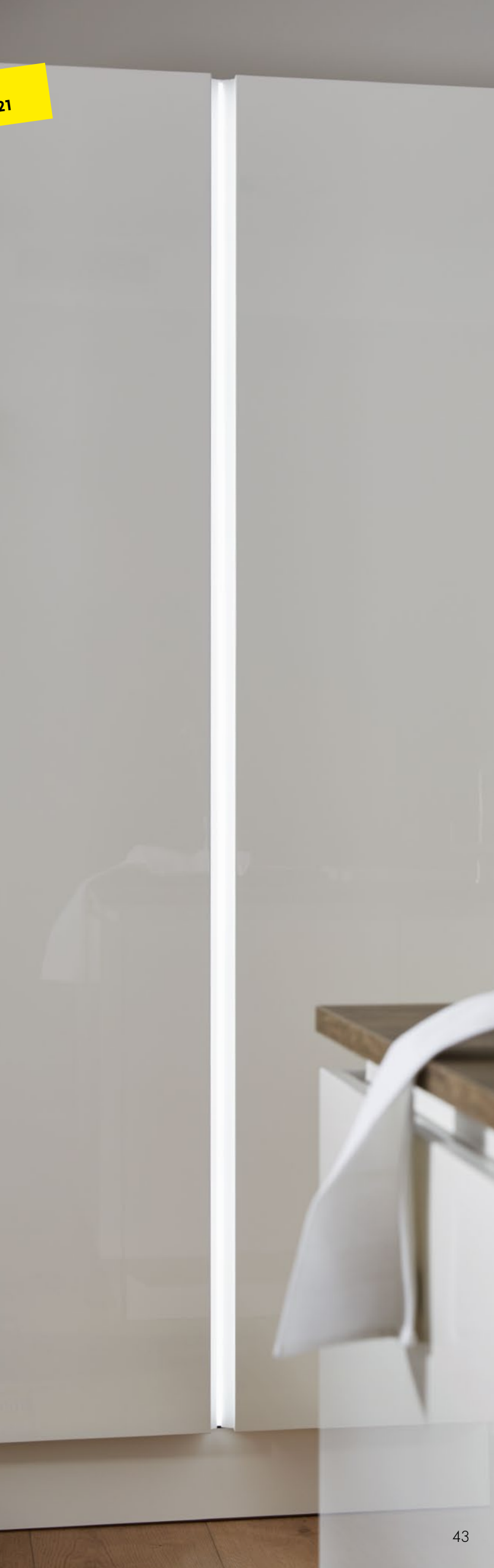



Larder and appliance units with uninterrupted door

Uninterrupted door, anti-warp fitting included

The new uninterrupted doors on tall and appliance units give you new creative flexibility in a way never seen before. Uncompromising quality is guaranteed by an anti-warp fitting that is provided as standard. Appliance units even have two of them.

Available in these ranges: ARTWOOD*), PLUS, SOFT LACK, NOVA LACK, TAVOLA, FERRO, PORTLAND, LEGNO

*) not in 2250 mm height

Larder units

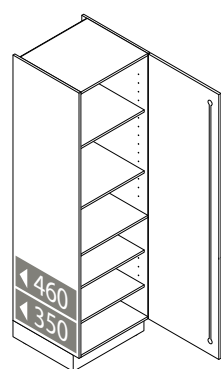

LARDER UNIT

1 uninterrupted door
1 anti-warp fitting
Shelves, depending on unit height

VDD 30 - 150 / -195 / -210 / -225
VDD 40 - 150 / -195 / -210 / -225
VDD 45 - 150 / -195 / -210 / -225
VDD 50 - 150 / -195 / -210 / -225
VDD 60 - 150 / -195 / -210 / -225

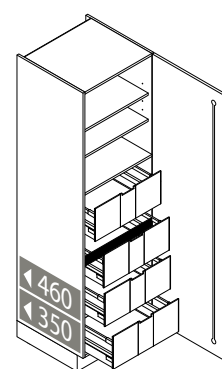

LARDER UNIT

1 uninterrupted door
1 anti-warp fitting
4 interior pull-outs
Shelves, depending on unit height

VID 40 - 150 / -195 / -210 / -225
VID 45 - 150 / -195 / -210 / -225
VID 50 - 150 / -195 / -210 / -225
VID 60 - 150 / -195 / -210 / -225

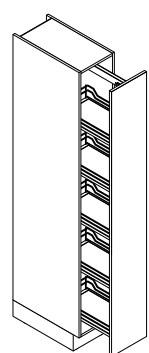

LARDER UNIT

1 front pull-out
with uninterrupted door
Pull-out shelves,
depending on unit height

VVAD 30 - 150 / -195 / -210 / -225
VVAD 40 - 150 / -195 / -210 / -225

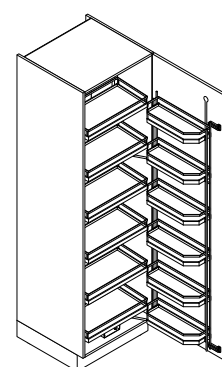

LARDER UNIT

1 uninterrupted door
1 anti-warp fitting
Storage baskets,
depending on unit height

VVKD 30 -195 / -210 / -225
VVKD 40 -195 / -210 / -225

Appliance housings

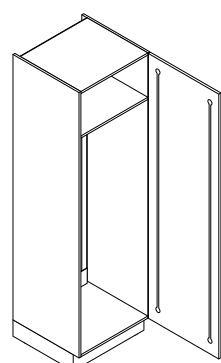

APPLIANCE UNIT WITH UNINTERRUPTED DOOR

including 2 anti-warp fittings
1 aperture for fridge
Shelves, depending on unit height and appliance recess

Height 1500 mm
GKDD 150-88
GKDD 150-103*)
GKDD 150-123*)
GKDD 150-144

Height 1950 mm
GKDD 195-144
GKDD 195-179*)

Height 2100 mm
GKDD 210-144
GKDD 210-179*)

Height 2250 mm
GKDD 225-179*)

*) also available with electrically motorised ejector: add article number: [...] -E

Utility room

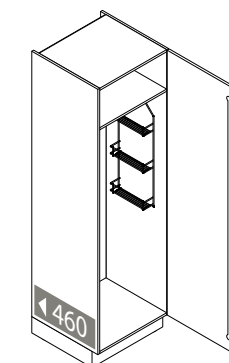

BROOM CUPBOARD

1 uninterrupted door
1 anti-warp fitting
Hook rail, hose and appliance holder with
storage baskets

VBD 30 - 150 / -195 / -210 / -225
VBD 40 - 150 / -195 / -210 / -225
VBD 45 - 150 / -195 / -210 / -225
VBD 50 - 150 / -195 / -210 / -225
VBD 60 - 150 / -195 / -210 / -225

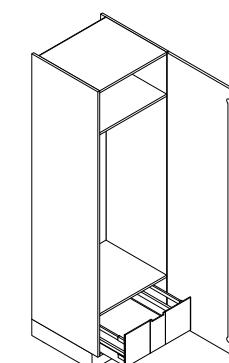

HALLWAY UNIT

1 uninterrupted door
1 anti-warp fitting
1 garment rail
2 fixed shelves
1 interior pull-out

VGAD 60 -195 / -210 / -225

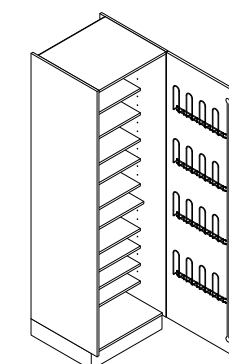

SHOE CUPBOARD

1 uninterrupted door
1 anti-warp fitting
Shoe rack on door
Adjustable shelves, depending on unit height

VSLD 60 -195 / -210 / -225

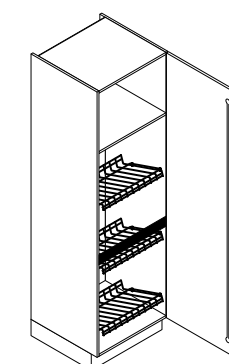

BEVERAGE CRATE UNIT

1 uninterrupted door
1 anti-warp fitting
1 fixed shelf
Carriers for bottle crates

VGLD 60 -195 / -210 / -225

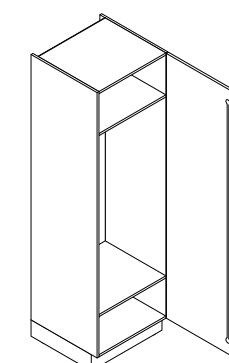

HALLWAY UNIT

1 uninterrupted door
1 anti-warp fitting
1 garment rail
2 fixed shelves

VGD 60 -195 / -210 / -225

Filler panels

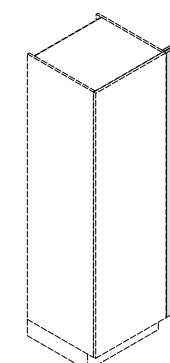

FILLER PANEL UNINTERRUPTED, IN FRONT FINISH

1 cut edge (facing wall)

30 - 100mm
SPD 1 -150 / -195 / -210 / -225

101 - 300mm
SPD 2 -150 / -195 / -210 / -225





Wall unit height 105 cm

This is where you will find all the information you need for planning a kitchen with our new wall unit height of 105 cm.

The extra 15 cm not only frees up more storage space but, above all, new options in designing the kitchens you craft.

From the simple wall unit to glass display cabinets: the sky's the limit.

With immediate effect, the wall units in 105 cm height now come with the concealed wall-mounting fitting. As from 1.1.2021, this will also be used for all other wall-unit heights.

Wall units

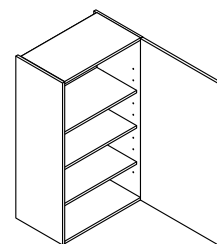

WALL UNIT

1 door
3 adjustable shelves

H 30/35/40/45/50/60 - 105

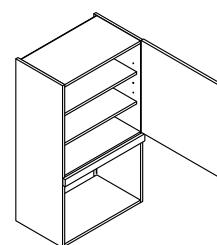

WALL UNIT FOR MICROWAVE

1 door
2 adjustable shelves
1 fixed panel

1 aperture for microwave, 330 - 399 mm
HM 50/60 - 105 - 399

1 aperture for microwave, 429 - 450 mm
HM 50/60 - 105 - 450

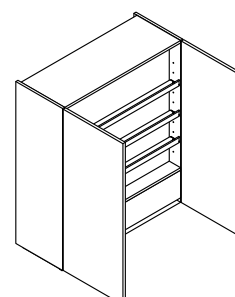

SURROUND FOR INTEGRATED COOKER HOOD

with rear panel set forward, metal spice racks

HWU 60-105 (1 door)
HWU 90-105 (2 doors)

Shelf units

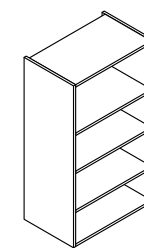

WALL SHELF UNIT

3 adjustable shelves
Inside depth 347 mm

**HR 15/20/25/30/35/40/
45/50/55/60 - 105**

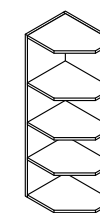

SPACE-FILLER OPEN SHELF WALL UNIT, ANGLED

Width 190 - 300 mm,
Please specify dimension
3 fixed shelves
Inside depth 354 mm

HRSA 30 - 105

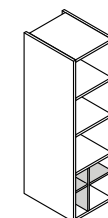

WALL SHELF UNIT

2 adjustable shelves
Shelf depth 370 mm / interior depth 347 mm

1 cross insert
HR1V 30 - 105

2 containers
HR2V 30 - 105

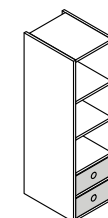

available in all carcass finishes as well as genuine lacquer soft mat

available versions for push-in elements:

EFB veneer, oak barolo
EFP veneer, oak pinot

Display units

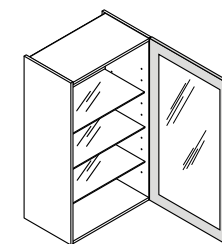

WALL UNIT WITH GLASS DOOR DN

1 glass door with aluminium frame
and handle profile all round
3 adjustable glass shelves

HVDN 40/45/50/60 - 105

available finishes:
Frame manganese bronze / bronze Parsol glass
Frame black mat / black tinted glass

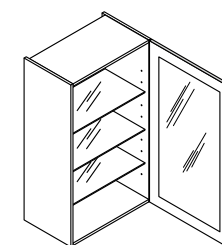

WALL UNIT WITH HANDLELESS GLASS DOOR

1 flush-fitting glass door
3 adjustable glass shelves

with aluminium frame in stainless steel look (DE)
HVDE 40/45/50/60 - 105

with aluminium frame in black mat (DS)
HVDS 40/45/50/60 - 105

Filler panels,
filler profiles
and
visible side

HPL 1 - 105
HPL 2 - 105

HP 1 - 105
HP 2 - 105
HP 3 - 105
HPE 105
HPE 65 - 105
HPE 90 - V1 - 105
HPE 90 - V2 - 105
HPE - V1 - 105
HPE - V2 - 105

SSF - H 105 - L
SSF - H 105 - R

**BEST
SELLER**

For a look of unique homeliness: black

We have extended the range of furniture elements in black for homely looking kitchens perfectly communicating with the rest of the home. Options range from display units with black aluminium frame to the black lamella plinth.

Display units with black anodised aluminium frame

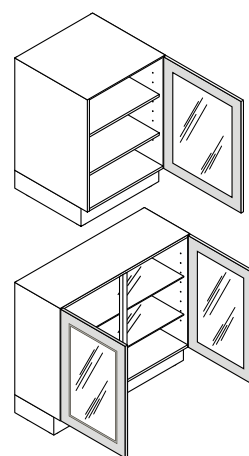

BASE UNITS

Carcase height 750 mm / carcass depth 560 mm
UDDN 40/45/50/60/80/90/100/120

Carcase height 750 mm / carcass depth 350 mm
UDDN 40/45/50/60/80/90/100/120 - 75 - 39

Carcase height 900 mm / carcass depth 350 mm
UDDN 40/45/50/60/80/90/100/120 - 90 - 39

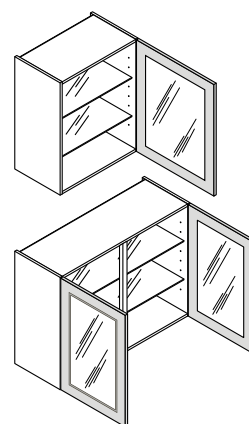

WALL UNITS

Carcase height 600 mm:
HVDN 40/45/50/60/80/90/100/120 - 60

Carcase height 750 mm:
HVDN 40/45/50/60/80/90/100/120 - 75

Carcase height 900 mm:
HVDN 40/45/50/60/80/90/100 - 90

Carcase height 1050 mm:
HVDN 40/45/50/60 - 105

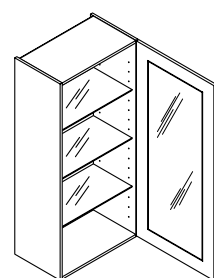

DRESSER UNITS

HAVDN 45/50/60 -116 / -131 / -146

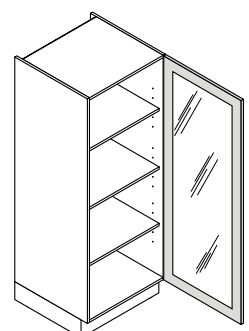

LARDER UNITS

Carcass depth 560 mm

Carcass depth 350 mm:

VDN 40/45/50/60 - 105
VDN 40/45/50/60 - 135
VDN 40/45/50/60 - 150
VDN 40/45/50/60 - 195
VDN 40/45/50/60 - 210
VDN 40/45/50/60 - 225

VDN 40/45/50/60 - 105 - 39
VDN 40/45/50/60 - 135 - 39
VDN 40/45/50/60 - 150 - 39
VDN 40/45/50/60 - 195 - 39
VDN 40/45/50/60 - 210 - 39
VDN 40/45/50/60 - 225 - 39

Available
from 1.1.2021

Top-mounted units with tambour door in glass look black mat and gloss black

Is your customer looking for an idea to upgrade a kitchen to reflect the latest trends? Here's another option that's equally as simple as it is practical.

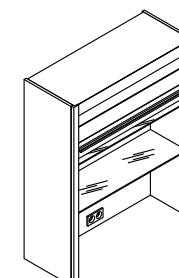

Carcass height 1160 mm:

HAJGO 60 - 115
HAJGO 90 - 115

HAJGO 60 - 115 - 48
HAJGO 90 - 115 - 48

HAJGO 60 - 115 - 58
HAJGO 90 - 115 - 58

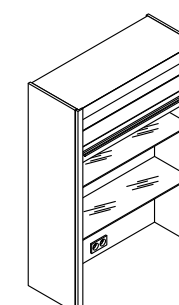

Carcass height 1310 mm:

HAJGO 60 - 130
HAJGO 90 - 130

HAJGO 60 - 130 - 48
HAJGO 90 - 130 - 48

HAJGO 60 - 130 - 58
HAJGO 90 - 130 - 58

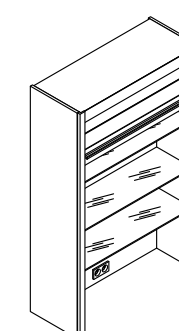

Carcass height 1460 mm:

HAJGO 60 - 145
HAJGO 90 - 145

HAJGO 60 - 145 - 48
HAJGO 90 - 145 - 48

HAJGO 60 - 145 - 58
HAJGO 90 - 145 - 58

Available in finishes: **GSS** Glass look, black mat • **GSH** Glass look, gloss black



SOCKET ELEMENT, 2-WAY / 1X USB - EVOLINE® BACKFLIP

For fitting in worktops/counter elements in a max. thickness of 50 mm

Black both inside and out

D/A/NL etc: **SEBACKF-S-F**
F/BE/PL etc: **SEBACKF-S-E**
GB etc: **SEBACKF-S-G**

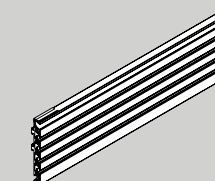

PLINTH PANEL WITH LAMELLA

Length 300 - 4,400 mm
Heights: 90/120/150/170 mm

SOB LAM

**90° CORNER FOR PLINTH PANEL
WITH LAMELLA**

Outside corner **SOE-LAM-AUS**
Inside corner **SOE-LAM-IN**

available finishes:
SW1 black
ALE steel look





Even more options

Our 2021 innovations give you, as a retailer, a whole host of new tools to configure your customers' kitchens in exactly the way they want: from the digital media wall and top-mounted units with lift-up door, elegantly concealing larger-type appliances, to Ozonos Aircleaners – you can make every wish come true.

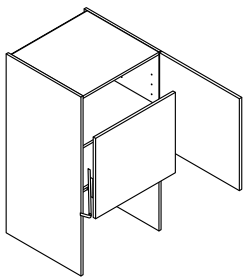

TOP UNIT WITH LIFT-UP DOOR

Height 1160-1188 mm, Carcase depth 560 mm	Height 1310-1338 mm, Carcase depth 560 mm
1 door 1 adjustable shelf 1 lift-up door	1 door 1 adjustable shelf 1 lift-up door
HAL 60-115-58	HAL 60-130-58
Height 1460-1488 mm, Carcase depth 560 mm	Available in the following ranges: Manhattan Uni, Manhattan, Lucca, Artwood, Feel, Lux, Metal, Stone, Titan, Plus, Trend Lack, Flair, Soft Lack, Ferro, Portland, Tavola, Nova Lack and Legno
1 door 1 adjustable shelf 1 lift-up door	
HAL 60-145-58	

Available
from 1.1.2021



27" MEDIA WALL

for image and sound reproduction via HDMI connection

available options: **WLG** white glass lacquered, **SLG** black glass lacquered

	1200 mm	1500 mm gesture control inclusive
for 560 mm high recess In conjunction with 40 mm thick worktops	MW 120-56	MW 150-56
for 575 mm recess height In conjunction with 25 mm thick worktops	MW 120-57	MW 150-57
for 588 mm recess height In conjunction with 12 mm thick worktops	MW 120-59	MW 150-59

27" MEDIA WALL, PRECONFIGURED

for image and sound reproduction via HDMI connection,
preconfigured incl. router, voice control module and Google Nest hub

available options: **WLG** white glass lacquered, **SLG** black glass lacquered

	1200 mm	1500 mm gesture control inclusive
for 560 mm high recess In conjunction with 40 mm thick worktops	MW 120-56-KF	MW 150-56-KF
for 575 mm recess height In conjunction with 25 mm thick worktops	MW 120-57-KF	MW 150-57-KF
for 588 mm recess height In conjunction with 12 mm thick worktops	MW 120-59-KF	MW 150-59-KF

GESTURE CONTROL

as a surface-mounted version
for flush-mounted sockets

To control up to 4 lighting scenarios

white **GES-BASE-A-W**
black **GES-BASE-A-S**

RADIO CUBE

as a control element
for up to 4 lighting groups

GES-CUBE-LED

as an additional control element
for the radio cube GES-CUBE-LED

GES-CUBE

VOICE CONTROL MODULE

to connect the radio cube or gesture control
with the "Google Assistant" voice assistant

GES-VC

SENSITIVE SWITCH UNIT

to control one lighting group

Concealed installation
under worktops is possible

GES-LED-FOL

Now available in all
carcase mat colours!

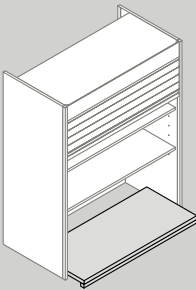

PULL-OUT SHELF

for top-mounted units
HAJ..., HAJV..., HAJGO..., HAL...
for carcase depth 560 mm / 460 mm
with fittings mounted under the shelf

HAAB ...

Now also available for flap-door units
in 450 mm height!

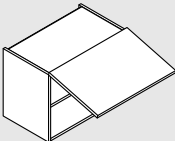

ELECTRIC DRIVE FOR FLAP-DOOR UNITS

HK ...-45 (from 45 cm width)

EMA



OZONOS AIRCLEANER

eliminates odours, germs, viruses etc. by means of UV-C light
Ozonos AC1, mounting foot, remote control

for permanent use in room air with a normal ozone concentration of 0.048 ppm	for temporary use/day in room air with an elevated ozone concentration of 0.115 ppm
White AC-1-SCHWARZ Silver AC-1-SILBER Black AC-1-WEISS	White AC-1-PLUS-SCHWA Silver AC-1-PLUS-SIL Black AC-1-PLUS-WEISS

**BEST
SELLER**
INCLUDED

Secure sales, cleverly planned

For the next kitchen season, Nolte Küchen will once again be providing all manner of support for your sales pitch:

- Decors that follow the latest trends while at the same time boosting sales
- Inspiration for planning individually tailored kitchens
- Noticeable enhancement of your exhibition
- Innovations which, for all their attractiveness, are above all one thing: easy to sell

But the best thing about the 2021 collection is the fact that all the new products have what it takes to become bestsellers.



**BEST
SELLER**

On-trend decors

The new decors for 2021 impress with their up-to-date look and sure saleability.

From oak graphite silver and volcanic oak to white concrete from STONE or the cement decors from LUCCA – this is the spectrum of your future bestsellers.



**BEST
SELLER**

The crowing glory for MatrixArt

You can now also illuminate the vertical MatrixArt recessed handle profile and create a further highlight in handleless kitchens.

105 cm wall units – Symbiosis of storage space and design

Our new wall unit height of 105 cm not only gives you new options in kitchen design, it is also unbeatable in terms of storage space.

**BEST
SELLER**



**BEST
SELLER**

For a look of unique homeliness: black

No matter whether glass display cabinets, tambour-door units or accessories. Elements in black let you bring on-trend homeliness into the kitchens you plan.

**BEST
SELLER**

Perfect throughout

Uninterrupted doors on tall units and appliance housings perfect the look of kitchens planned in a modern style.

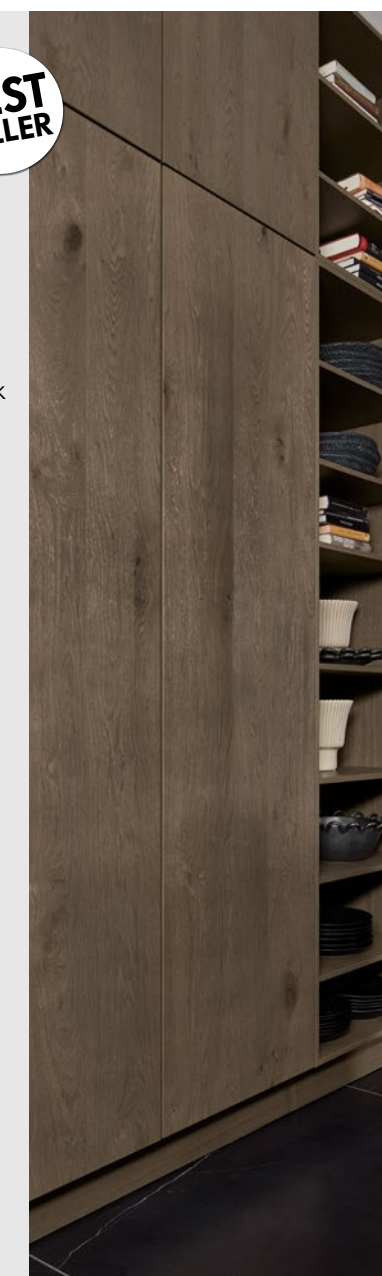

The kitchen is the room of rooms.
We probably *live* more,
and more *intensively*,
here than anywhere else in the home.
It is the place where
we meet, where we encounter others.
As family or friends.
As a couple.
We *cook, eat* and *enjoy* ourselves
in the kitchen. And sometimes we have
all the time in the world as we do so.
We argue. And *make up again*.
We read, write, send emails, post messages.
And maybe philosophise a little.
And – quite secretly – the kitchen sets
the rhythm of our day.
Good morning. Then midday. Then evening.
And sometimes night ...
Which is *why we love* the kitchen.

Living in the kitchen. nolte